

RIVERVIEW HIGH SCHOOL MUSIC DEPARTMENT

One Ram Way, Sarasota, FL 34231

(941) 923 – 1484, Ext. 64329

(941) 373 – 7473, Fax



Tamara Lewis

Director of Bands

Zach McKee

Associate Director

Chuck Evans

Associate Director

Greetings Directors,

Thank you for selecting the Riverview Performing Arts Center (RPAC) at Riverview High School as your site for the State Concert Band Music Performance Assessment. We are looking forward to serving our Central Florida schools as we strive to provide the best possible educational performance opportunity for you and your students. The RHS students, parents, and staff are working very hard to ensure that everyone has a great experience.

Please pay close attention to the **arrival and departure** section and note that limited concessions will be available and that meals can be pre – ordered. A directors' hospitality room will be provided and located in the FBA Office as an opportunity for our directors to get together and collaborate between performances. The adjudicators will have a separate room for their meals, and we ask that the adjudicators are not interrupted during their meal breaks.

To help us prepare for your arrival, please click on the link below and complete the electronic form: <https://forms.office.com/r/vqN0Z4n2TF>

If you have any questions regarding event procedure, school layout, special accommodations, or clarifications, please do not hesitate to contact us.

Tamara.Lewis@sarasotacountyschools.net

Zachary.McKee@sarasotacountyschools.net

Chuck.Evans@sarasotacountyschools.net

We wish you and your students the best MPA performance possible and hope you have a great experience at Riverview High School.

A handwritten signature in cursive script that reads "Tamara Lewis".

Tamara Lewis
Director of Bands
Riverview High School



STATE CONCERT MPA GENERAL INFORMATION

Riverview High School, 1 Ram Way, Sarasota, FL, 34231

Arrival: When you arrive, please follow the prescribed route through the front office breezeway (see map on page 4). All parties will be required to pass through our *Open Gate* security system and instrument cases will need to be checked. To expedite your entrance, please minimize the number of extra bags / items that are not needed for your performance. Directors are also strongly encouraged to wear (school) ID badges at the entrance for security purposes. During the school day, other visiting adults (audience members) will be required to go through the Raptor system in the front office.

FBA Office / Directors' Hospitality: Directors will then check in at the FBA Office which is located inside the music building. Upon checking in, please leave your adjudicator scores and seating chart. If you have multiple bands, you may leave all the needed information upon arrival for your convenience or submit these prior to each band's performance. There will be plenty of water, sodas, and snacks, so please grab something to eat and drink while you are here! At the conclusion of the event, the main gates / office breezeway will also serve as the exit point for all directors, students, and spectators.

Buses: Dismissal time at RHS is 2:15 PM. For this reason, visiting buses are not able to arrive or be in the bus loop from 1:45 – 2:30 PM on weekdays. Upon arrival (either ***before*** 1:45 PM or ***after*** 2:30 PM), buses may drop off and pick band members in the loop labeled "bus loop". Outside of the 1:45 PM – 2:30 PM time frame, buses will be permitted to remain parked around the RHS bus loop. However, any buses that are around during the 1:45 PM – 2:30 PM time frame will need to park at Sarasota Technical College which is located 1.5 miles east on Beneva Road (see map below).

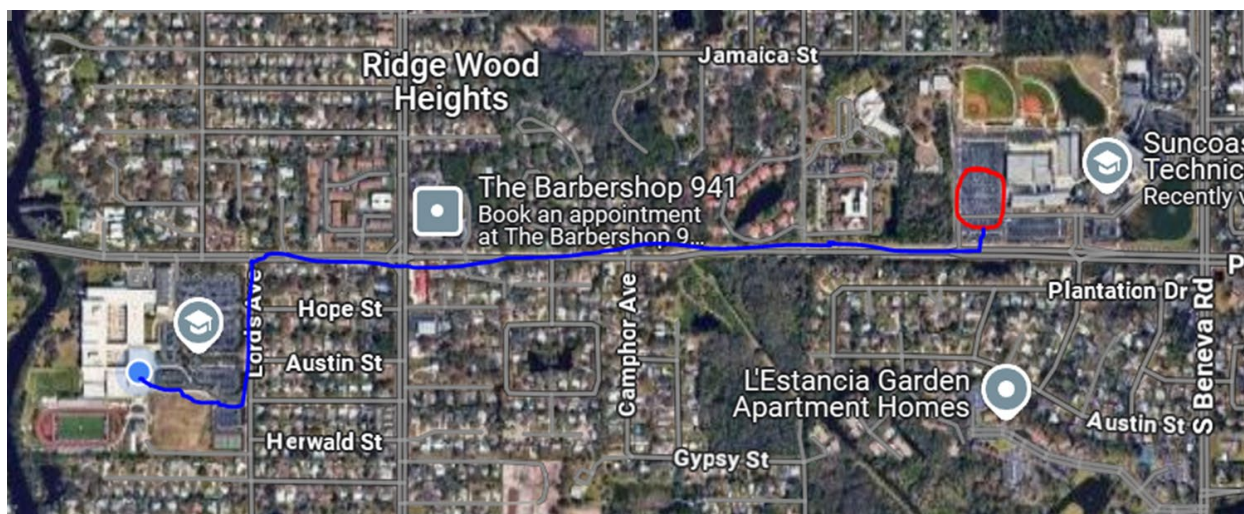

Parking: Guests can park in visitor parking at the main entrance to the school. **PLEASE DO NOT park vehicles anywhere in the bus loop!!** For bus / trailer access, please see the map on page 4.

Instrument and Case Storage: Cases and instruments can be stored, if necessary, in the RPAC prior to and after your band's performance block. However, whenever possible, please leave your cases on the bus.

Warm – Up Room: The warm – up room will be furnished with chairs and stands as well as some percussion equipment, and a Harmony Director will also be available for use. Please follow the appropriate routes to and from the warm – up room (which will be posted) to avoid any traffic jams. A student guide will be available to guide you around campus, but the priority for managing warm – up time is the responsibility of the director. Your guide will remind you of warm – up times should you need it.

Percussion Equipment: The following percussion equipment will be available on stage and in warm up:

• 4 Adams timpani (4 Ludwig in warm up) (5 th 20" timpani available w/ advance request)	• 4.3 – Octave Musser marimba (5.0 Marimba One Izzy available w/ advance request)
• Concert bass drum	• Chimes (Musser)
• Orchestra bells	• Gong (40")
• Xylophone (Musser)	• Percussion cabinet for trap table (stage only)
• Vibraphone (Musser)	• Piano (Advance written notice please!!)

Please be aware that no sticks, mallets, snare drums, instrument stands, cymbals, auxiliary percussion or towels (except for the concert bass drums) will be provided. If you forget something, please work with other bands / directors to borrow equipment. ***If you need a 5th timpani, a 5.0 – octave marimba, or a piano, please be sure to include that request when you fill out the electronic form listed on the previous page.***

Concessions: Concessions with drinks and snacks will be available in the RPAC lobby between sessions with (but please do not bring open food / drinks into the performance hall). If you would like to pre order Chick – Fil – A meals, you may use the link below no later than Friday, April 25th @ 3 PM

<https://forms.office.com/r/HbkPaG0J2y> (This is the only way to get Chick – fil – A sandwiches)!

RPAC Stage “Helpful Hints”

These helpful hints are only intended to ease your concern regarding our stage. This information is solely from our experience and is opinion of the hosting directors.

We have not found success when the students feel that they need to “fill the hall”. We do not suggest setting up far back or spreading out. The podium will be placed so that you can position your band just like you do in your band room. You are welcome to move anything, including the podium, to your liking.

- A 30 to 50 – member band may feel like the stage is quite large.
- A 50 to 70 – member band will probably feel comfortable on the stage.
- A 70+ member band may feel “tight” on stage, but the stage can accommodate 5 rows comfortably.

The band shell will amplify percussionists – these musicians should take care to play within the band sound. The best solution is to have the percussionists set up well in front of the back wall and play one dynamic lower than the page marking. Auxiliary instruments may sound soft from the podium but can be heard clearly in the hall.

In our experience, placing the tubas in the last row gives the most bass sound (from the podium – next to the timpani between 1 o’clock and 2 o’clock. You may not hear the tuba as much as you want, but the sound will project into the hall.

An overly confident oboe in the first row will sound out of balance easily.

The wooden stage is quite live when students move music and tap feet.

All students perform differently, especially regarding their age, spontaneous changes in confidence, and sometimes too much restraint. Students always play best when they play like they are in their own band room. Best of luck to everyone in their performances!

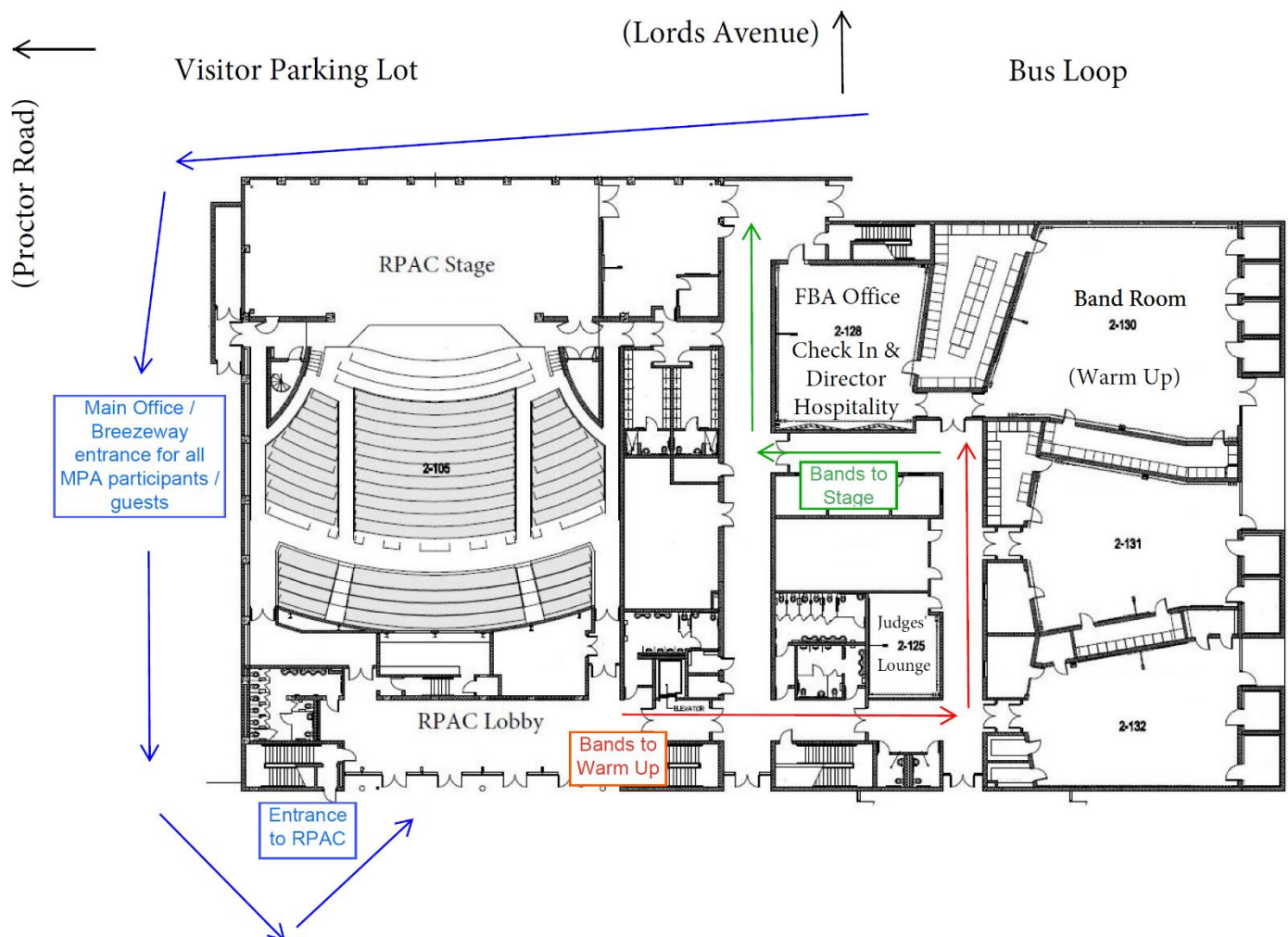
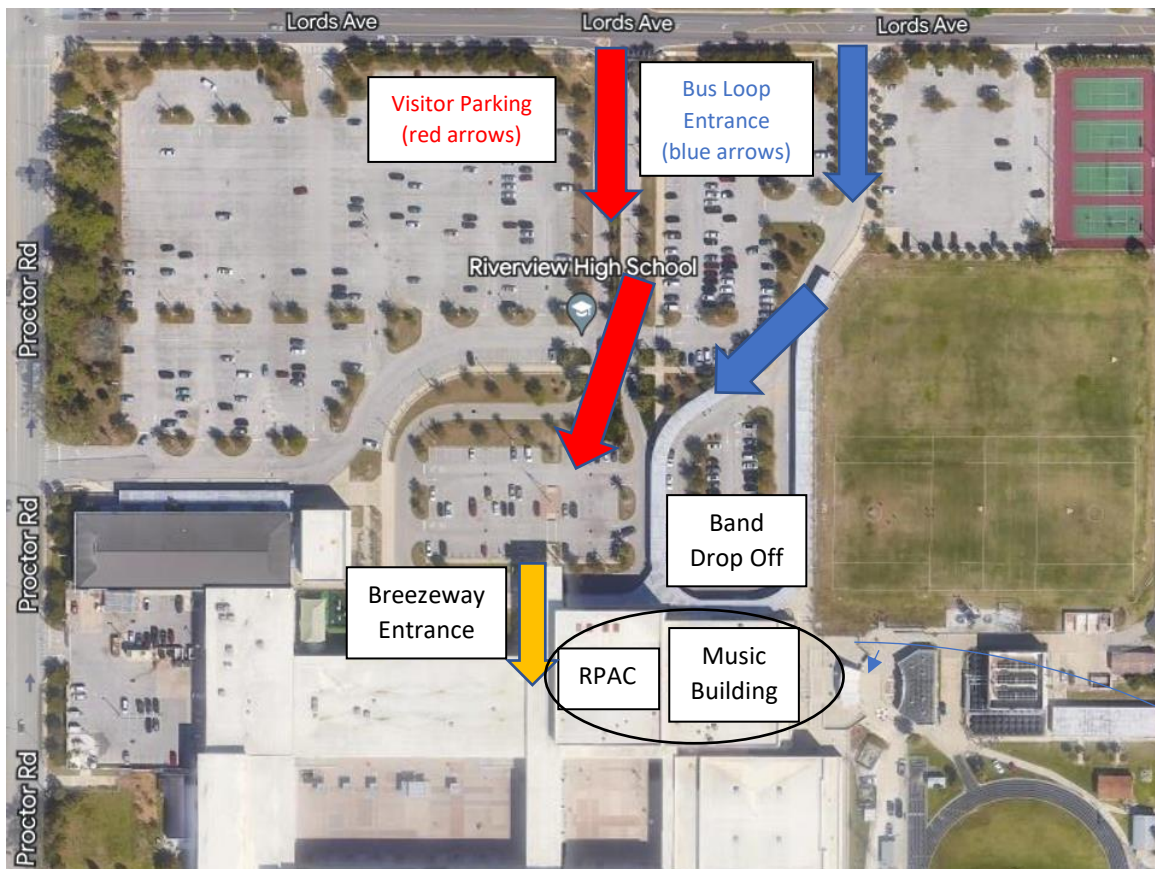

Stage Set up:

School: _____

Band Name (*if more than one band*): _____

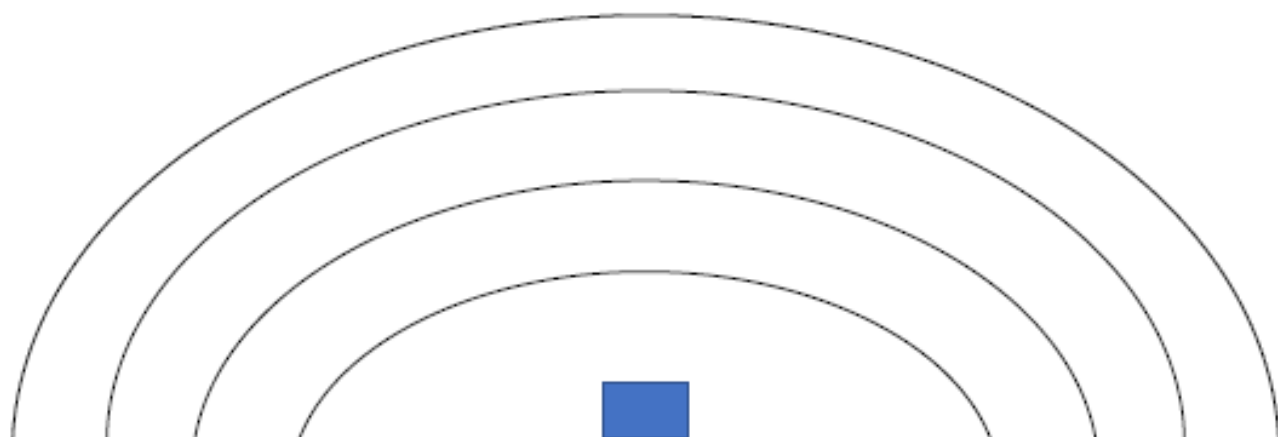

Please mark Chairs with an X, and stands with a O.

Row	Chairs	Stands
1		
2		
3		
4		
Percussion		

Do you need the piano? _____

Additional Notes:

You can also create your own set up, or use a set up generator like this one: <https://www.bgreco.net/band/>



**2025 FBA STATE
BAND MPA
BUS PARKING PASS**

VALID APRIL 28-30, 2025