

## **FLORIDA BANDMASTERS ASSOCIATION**

2024 State Solo and Ensemble MPA, State Jazz MPA, State Auxiliary MPA

March 22-23, 2024



**CENTRAL SITE | Horizon High School | 10393 Seidel Rd. Winter Garden, FL 34787**

### **Welcome to Horizon High School, Home of the Hawks!**

If you find that you have any additional questions or need more information about this site before the event begins, contact Charlene Cannon, Band Director: [charlene.cannon@ocps.net](mailto:charlene.cannon@ocps.net)

### **FBA Office**

The FBA Office for all events will be located in the Horizon High School Media Center. The FBA Office is for adjudicators and directors only, accompanists should not enter this area. Drinks and grab-and-go snacks will be available for directors throughout the event.

### **Horizon High School Entrance/Parking**

There are two entrances to Horizon High School. Both entrances are at traffic lights. The first light on Seidel Rd. closest to the 429 is where cars should enter and where buses enter to park (they enter at the second light to drop off, then drive back here to park). The second light on Seidel Rd. (Summerlake Groves St.) is just past the first light farther down Seidel Rd. and it will also look like the entrance to the Watermark Terrace neighborhood.

### **Bus Parking**

All buses should enter at the second entrance, drop off outside the auditorium, then drive to the first entrance and park in the main parking lot. Do not park buses outside the auditorium, this is only for drop off and pick up if needed. The main parking lot (as well as where you will carry/store your equipment) is not far from the auditorium, so you could plan for drop off outside the auditorium and pick up where your bus parked.

### **Car Parking**

Cars should enter at the first entrance and park in the main parking lot. Do not park cars outside the auditorium, we are an open site during spring break, and there will be teachers and OCPS staff parked here.

### **Jazz MPA Performances**

All performances will take place in the Horizon High School auditorium (800), which is on the left side of the school if you are looking at it from Seidel Rd. This is the building with the school

name on it. Warm-up will take place in the bottom of the 600 building, which is a short walk to the auditorium. Case storage will also be in this building.

### **Solo and Ensemble MPA Performances**

All performances will take place in the main classroom building, which is the large building in the center of the courtyard. This is a three story building with three hallways (400, 500, 600). Warm-up will take place in the cafeteria (700).

### **Auxiliary MPA Performances**

All performances will take place in the gym (300), which is the large building on the right side of the school as you are looking at it from Seidel Rd. The gym lobby can be entered from the courtyard or the parking lot. There will be a tarp on the floor and we will have a speaker with aux headphone jack input (lightning dongle) plus bluetooth capability.

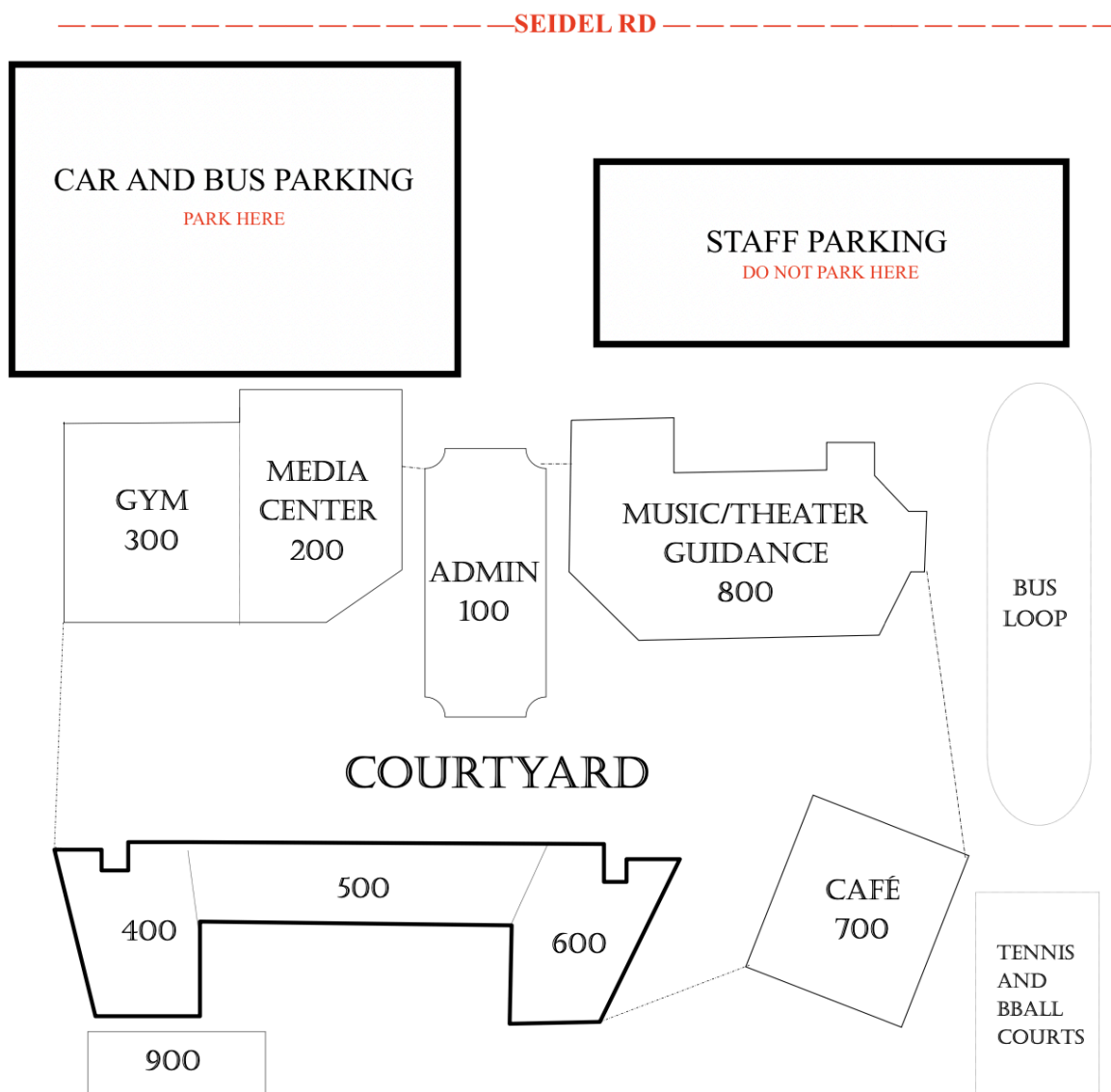



### **Concessions**

Please support our program by allowing your students to visit the concession stand. Our concession stand accepts cash and card.

Pulled Pork Sandwich \$6.00  
 Cheeseburger \$6.00  
 Hamburger \$5.00  
 Chips \$1.00  
 Candy \$2.00  
 Muffins \$3.00  
 Canned Soda \$2.00  
 Small Gatorade \$2.00  
 Water \$1.00

### **Stage: Jazz MPA**

Vibraphone, Grand Piano (with mic, levels may be controlled from sound booth in back of auditorium), 2 Solo Microphones

### **Percussion: Solo and Ensemble MPA**

Ensemble percussion rooms will include all large/rolling equipment:  
 Marimba (2), Vibraphone (1), Xylophone (1), Glockenspiel (1)

Chimes (1), Timpani (4), Bass Drum (1)

Solo percussion rooms are intended for snare drum solos and will not include equipment beyond an upright piano or a (weighted) keyboard.

### **Help Desk**

Horizon High School Band and Color Guard students will be volunteering at our event and looking forward to being helpful and accommodating to students, families, and directors visiting our campus. We will have a help desk in the middle of the courtyard (to answer questions about classroom locations, our campus is very easy to navigate as all performances will take place within the same building in the courtyard) and students will also be stationed outside the auditorium to assist directors as jazz bands arrive.

**Please share this link with your students and families, this includes the maps above and will be updated with room maps before the event:**

[www.tinyurl.com/horizonhsfbamaps](http://www.tinyurl.com/horizonhsfbamaps)