

Driving Directions

From the North:

Use I-95 SOUTH to I-595 WEST.

OR: use the Turnpike SOUTH to I-595 WEST.

Travel west on I-595 to the Davie Road exit. (Use caution due to heavy construction on I-595. Exits sometimes are relocated).

Exit on Davie Road going SOUTH. Go past the main entrance for the college and turn right at the Bailey Concert Hall marquee. Continue straight ahead until you reach Bailey Concert Hall.

From the South:

Use I-95 NORTH to I-595 WEST.

OR: use the Turnpike NORTH to I-595 WEST.

Travel west on I-595 to the Davie Road exit. (Use caution due to heavy construction on I-595. Exits sometimes are relocated).

Exit on Davie Road going SOUTH. Go past the main entrance for the college and turn right at the Bailey Concert Hall marquee. Continue straight ahead until you reach Bailey Concert Hall.

From the West:

Use I-75 SOUTH (Alligator Alley) to I-595 EAST.

Travel east on I-595 to the Davie Road exit. (Use caution due to heavy construction on I-595. Exits sometimes are relocated).

Exit on Davie Road going SOUTH. Go past the main entrance for the college and turn right at the Bailey Concert Hall marquee. Continue straight ahead until you reach Bailey Concert Hall.

On Campus Directions:

All buses will be directed to parking locations around campus once they have arrived at Bailey Concert Hall.

Parking:

If you are driving a personal vehicle or equipment truck onto campus, please understand that parking could be extremely difficult. Thursday & Friday are the end of exams, so they may be spaces available.

On-Stage Percussion Instruments:

Orchestra Bells	4 Timpani
Xylophone	Bass Drum
Marimba (Grand)	Vibraphone
Chimes	Tam Tam
*Grand Piano	

- Directors needing a piano must contact Neil Jenkins at least 10 days before your scheduled performance.
- * Broward College will not be providing other percussion equipment, sticks, or mallets. Be sure to bring your own.

There will be no sound amplification equipment provided.

Concession:

Bailey Concert Hall will be operating a concession stand at the site. Look for that menu to be posted in the near future.

Concert Hall Etiquette:

Bailey Concert Hall is a very large venue with a very large lower level seating area. The balcony will not be open to the public and will be used only by the judges.

In order to provide each ensemble with the highest quality performance experience and quality recording, the following will be in effect while you are in the Bailey Concert Hall:

- Cell Phone, Pagers, and all Electronic Devices with an On/Off switch, must be turned OFF or placed in SILENT MODE.
- Food and Beverages are NOT permitted in the Concert Hall.
- Instruments and instrument cases should be placed on the buses when possible or along the inside walls of the Concert Hall and not in the seating area.
- Restrooms are located in the lobby area of the Concert Hall.
- The audience is asked to remain seated and quiet during the entire performance of an ensemble. Shouting and yelling to friends on stage is not appropriate for this event and students should be instructed as to proper audience etiquette.
- Enter the Concert Hall only between a bands performance.

**Palmy Hall
Ground Floor**

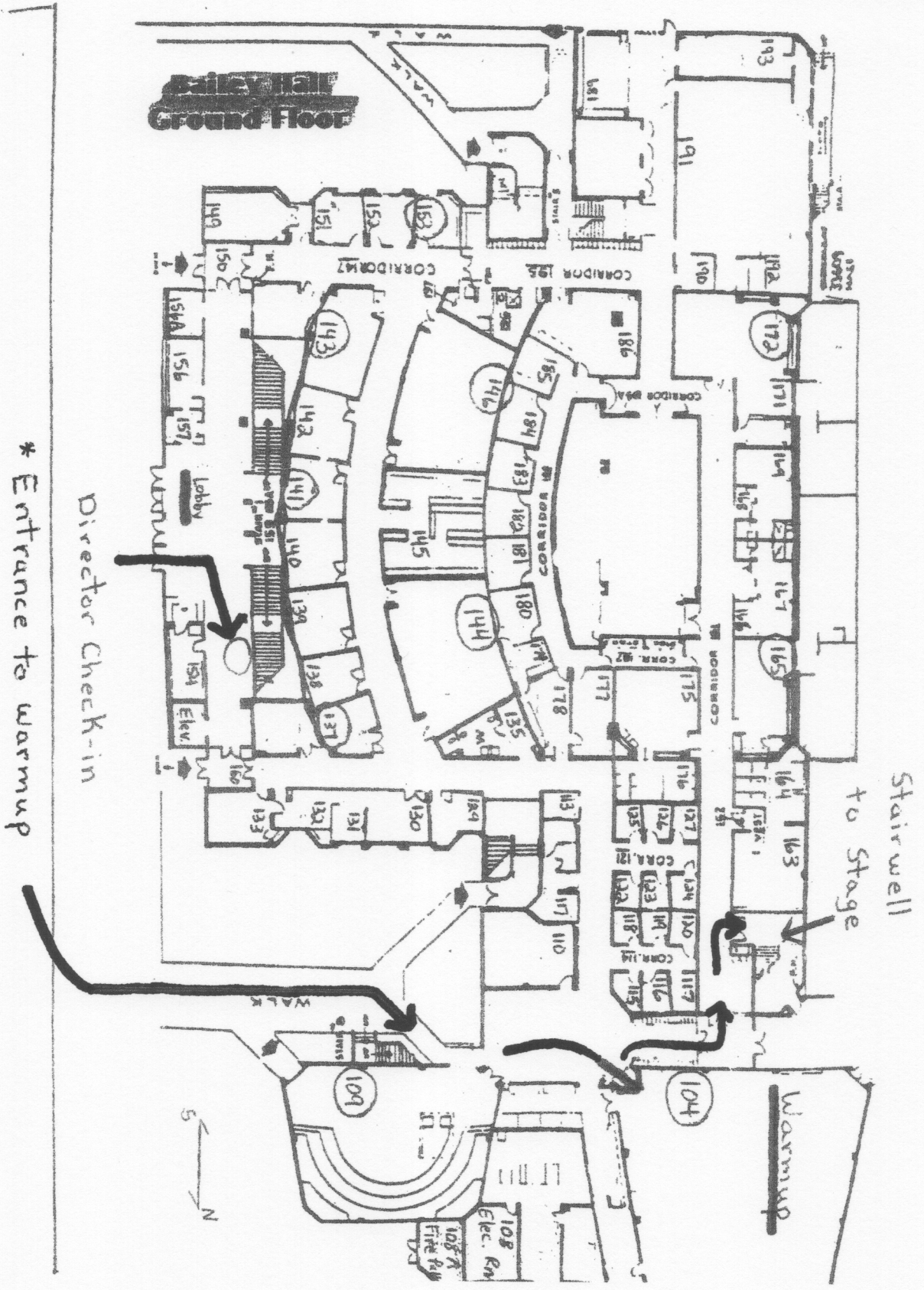

* Entrance to warmup

Director Check-in

Stairwell
to Stage

Warmup



To see all the details that are visible on the screen, use the "Print" link next to the map.

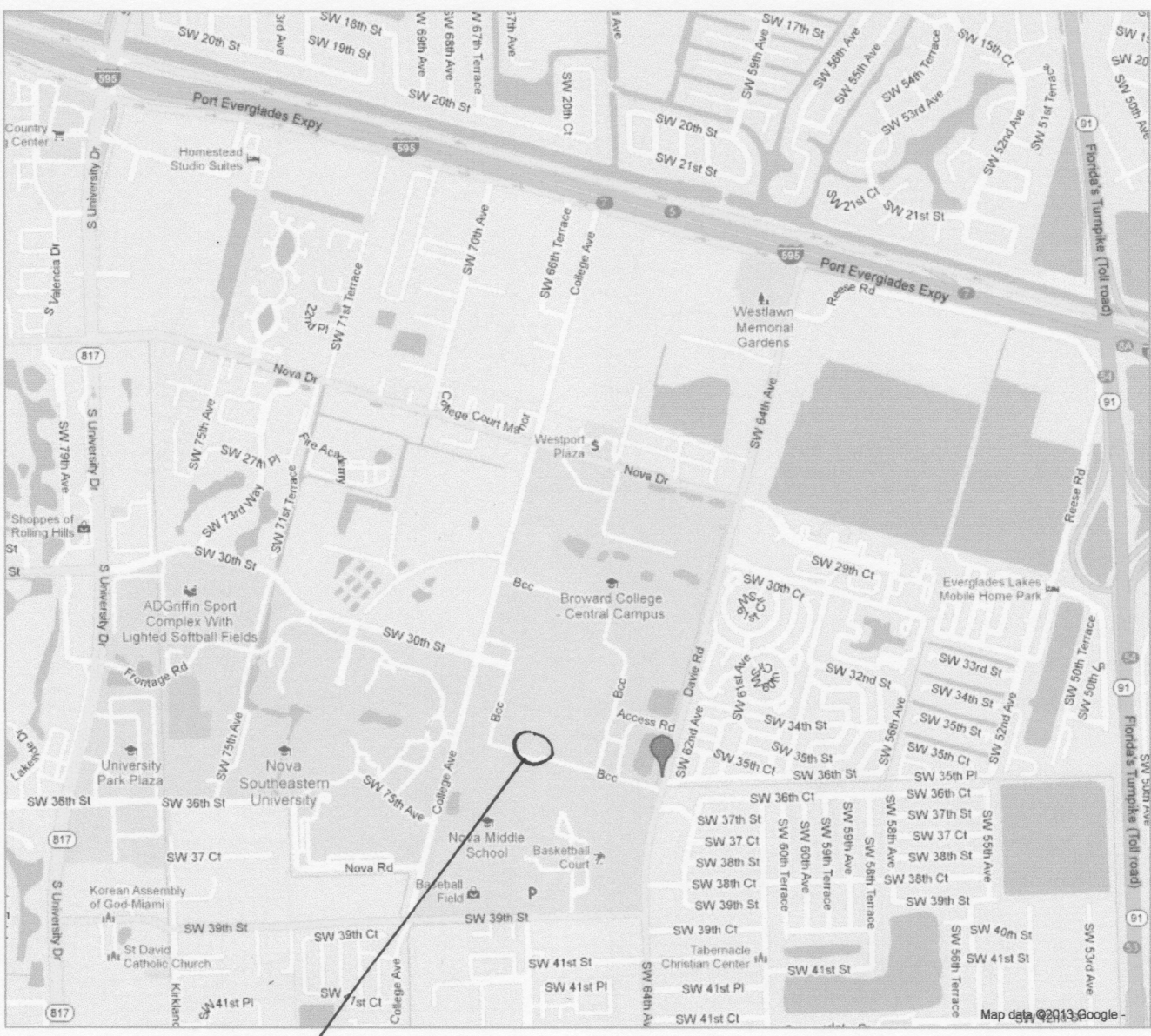

Bailey Concert Hall

Flow chart for Broward College South State Band MPA

Once you have arrived, you will need to proceed to the lobby area of the Bailey Concert Hall to sign in.

Bring your Scores (in three separate envelopes/folders), stage set up, and announcer form to the check in table.

If you are arriving early enough to hear other groups before going to warm-up, take your students into the Hall to be seated - entrance is up the stairs and on the 2nd level.

A band guide will be assigned to you when you check in.

A concession stand is available on the 2nd level of the lobby area.

PERFORMANCE ROUTING:

Warm-up will be in Room 104 (Band Rehearsal Room which is in the same building). Please try to leave all cases on your buses if possible. There will be limited case storage backstage. Keep any cases you have with you when leaving the warm-up room.

Your warm-up time is **30 minutes** which includes, getting seated, warm-up, and leaving the room to the stage. Your percussion section will be sent to the stage at 10 minutes before your performance time and the band will be sent at 5 minutes before your performance time.

Proceed out of warm-up to the right through the 1st set of glass doors, turning left through the 2nd set of glass doors. There is a stairway to the right that will take you up to the stage entrance.

You will be entering the stage from **STAGE LEFT**.

You will exit the stage to **STAGE RIGHT**.

After your performance, you will proceed to the auditorium where you can be seated to hear other groups, or exit down the stairs to the main lobby and out.